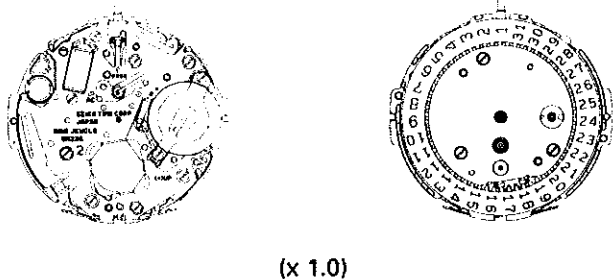

PARTS CATALOGUE

Cal. 6M23A

[SPECIFICATIONS]

		Cal. No.	6M23A
Item			
Movement		 <p>(x 1.0)</p>	
Movement size	Outside diameter	28.5 mm between 6 o'clock and 12 o'clock sides ø27.0 mm between 3 o'clock and 9 o'clock sides	
	Casing diameter	ø26.4 mm	
	Height	3.7 mm (3.9 mm including the battery portion)	
Time indication		3 hands, 24-hour hand and mode indicator	
Driving system		Step motor (4 pcs.)	
Additional mechanism		<ul style="list-style-type: none"> • Alarm function (24-hour indication system) • Stopwatch function (Up to 32 days) <ul style="list-style-type: none"> • It measures in 1/10 second increments for the first 60 minutes. • Automatic calendar (Year, month and date up to the year 2099) • Dual time function • Hands 0-reset adjustment function (including the date position adjustment) • Alarm test system • Confirmation sound for watch operation • Electronic circuit reset switch • Battery life indicator 	
Loss/gain		Monthly rate at normal temperature range: less than 15 seconds	
Regulation system		Nil	
Measuring gate by quartz tester		Use 10-second gate (in "CHRONO Ø MATCH" mode).	
Battery		SEIKO SR927W, Maxell SR927W, SONY SR927W, EVEREADY 399 Battery life is approximately 2 years. Voltage: 1.55V	
Jewels		9 jewels	

Disassembling procedureds Figs. : (1) → (61)

Reassembling procedureds Figs. : (61) → (1)

Lubricating: Types of oil	Oil quantity
∞ Silicone Oil 500,000 c.s.	∞ Normal quantity
➤ Moebius A	
∞ SEIKO Watch Oil S-6	

- Cal. 6M23A has two types of case structures as shown in the illustrations below.
 - Type 1 : The earth lead terminal is welded to the case ring, and they cannot be disassembled.
 - Type 2 : The earth lead terminal and the case ring are separately assembled to the case.

[Parts supply of the case ring and earth lead terminal of Type 1]

Only the case ring and earth lead terminal used in type 2 are available for supply as spares. Therefore, when the case ring of type 1 requires replacement, do as follows:

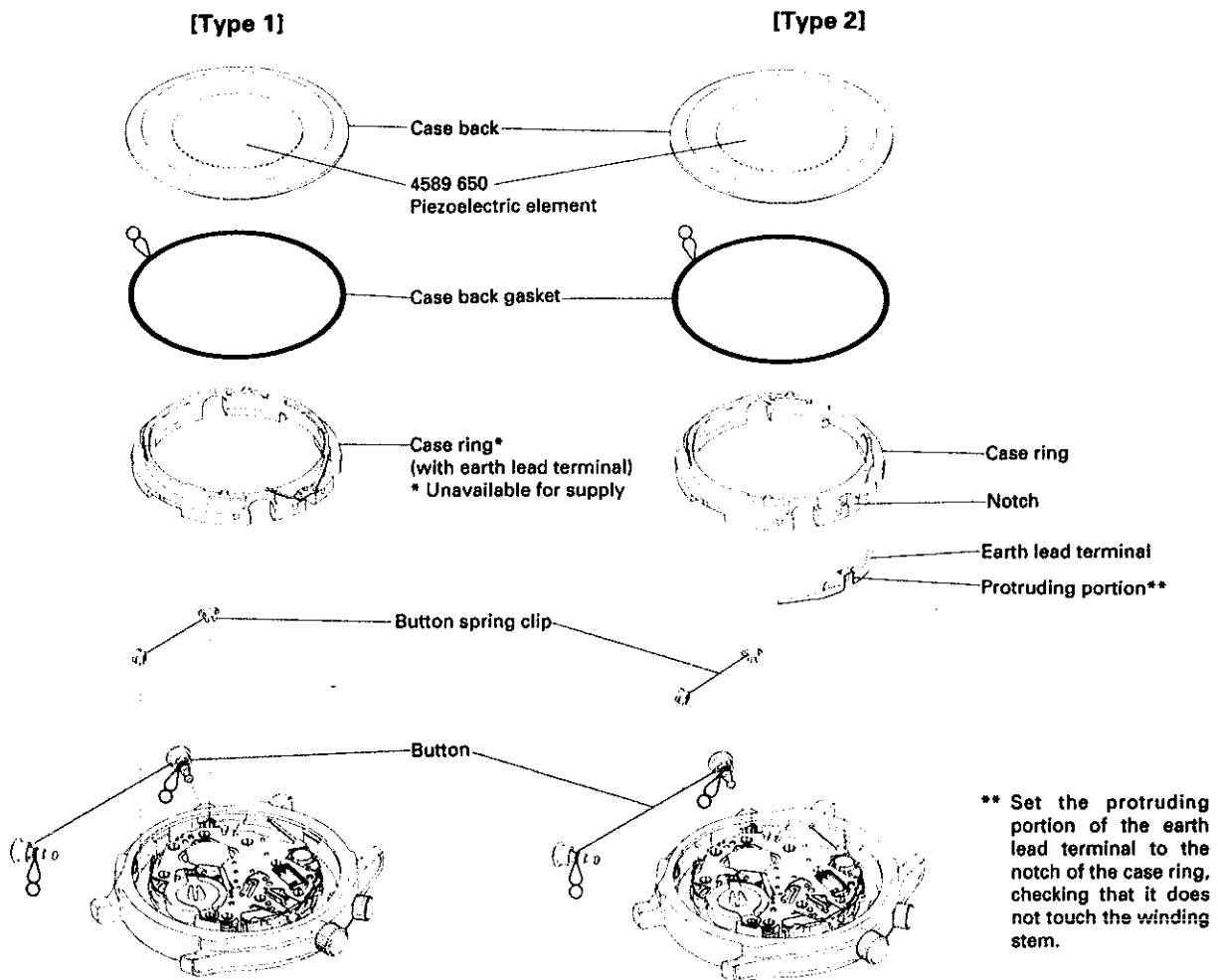

1. Only the earth lead terminal is defective:
You can use a type 2 earth lead terminal with the existing case ring.
2. The main-body of the case ring is defective:
Replace it with a type 2 case ring and earth lead terminal set.

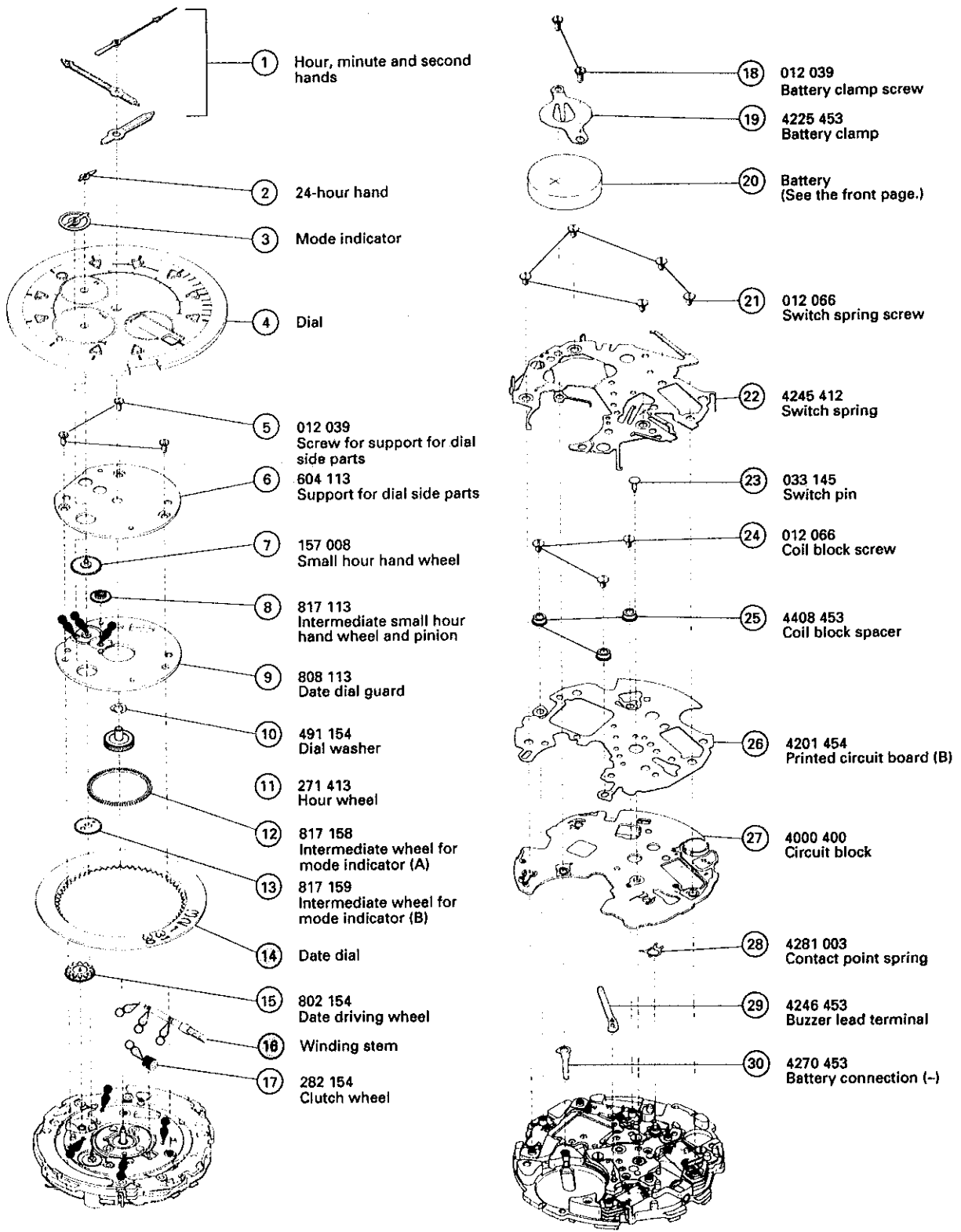

PARTS CATALOGUE

Cal. 6M23A



  Please see the remarks on the next page.

PARTS CATALOGUE

Cal. 6M23A

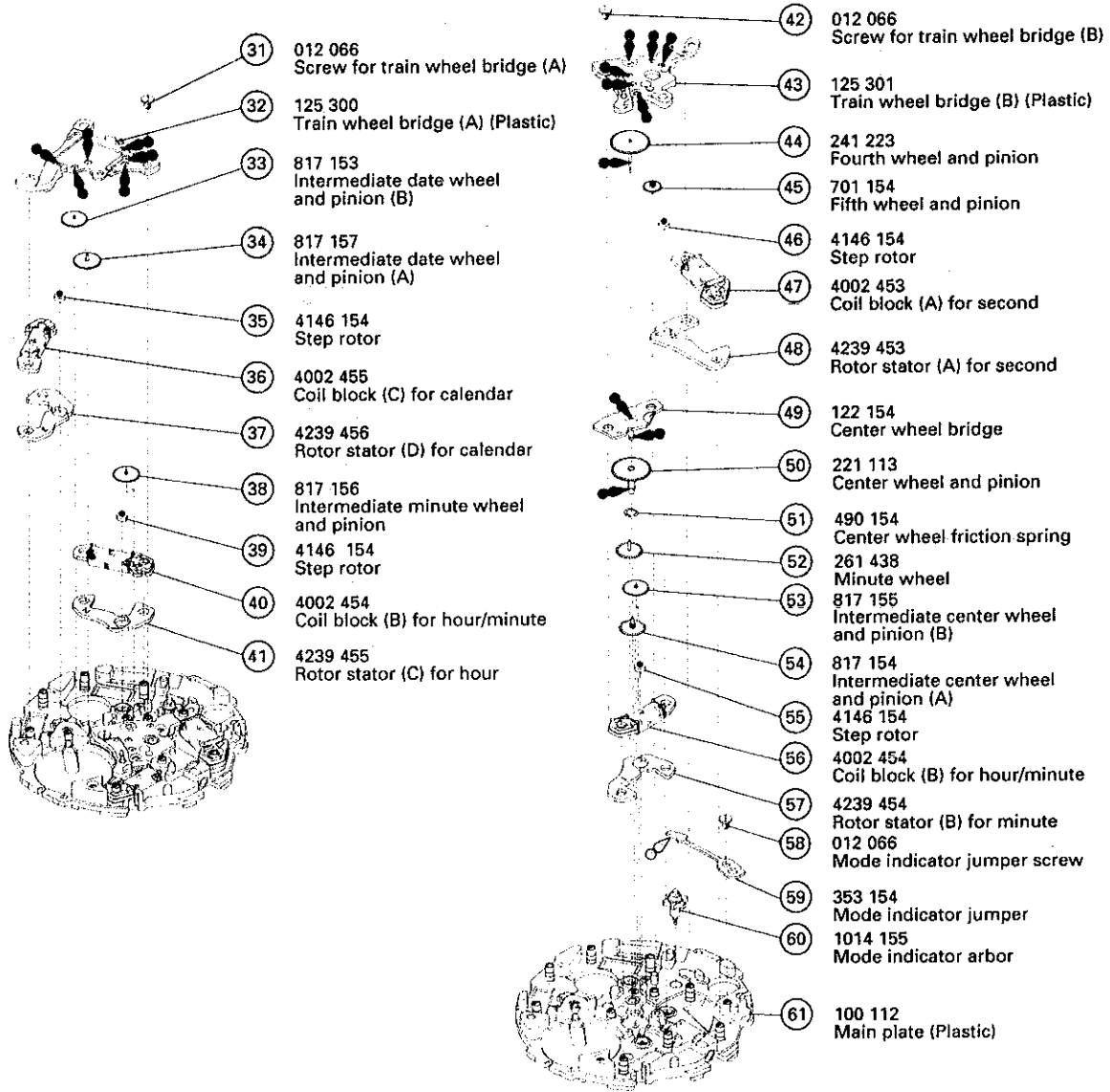

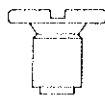
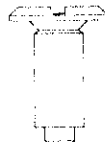
	<p>012 066</p> <ul style="list-style-type: none"> • Switch spring screw (5 pcs.) • Coil block screw (3 pcs.) • Screw for train wheel bridge (A) (1 pc.) • Screw for train wheel bridge (B) (1 pc.) • Mode indicator jumper screw (1 pc.)
	<p>012 039</p> <ul style="list-style-type: none"> • Screw for support for dial side parts (3 pcs.) • Battery clamp screw (2 pcs.)

Remarks:

- ⑭ Date dial
- ⑯ Winding stem

The type of date dial and winding stem are determined based on the design of cases. Check the case number and refer to "SEIKO Casing Parts Catalogue" to choose their corresponding types.

• For the remarks on assembling, disassembling and value checking of Cal. 6M23A, refer to "TECHNICAL GUIDE" section of "PARTS CATALOGUE/TECHNICAL GUIDE Cal. 6M13A".