

TIMEX

model

42

SERVICE MANUAL  
MODEL 42

*your* **TIMEX**

*Electric*

*Day Date*

*Watch*



13½ lig.

30.5 mm

1.20 in.

# the TIMEX Model 42 Movement

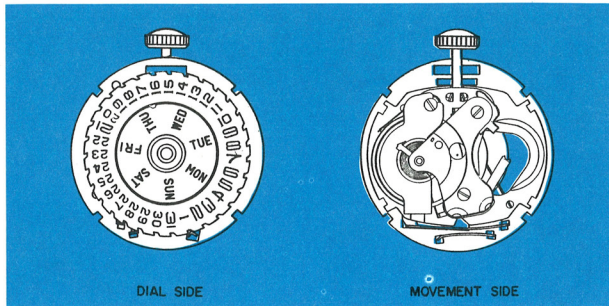

The Timex Model 42 is a  $13\frac{1}{2}$  ligne electric day-date movement. The Model 42 movement is similar to the Model 40 movement except that a day-date mechanism has been added. The power to drive the movement is supplied by a miniature energy cell. Power from the energy cell drives the balance. The balance drives the time train which, in turn rotates the hands and the day-date mechanism.

The day can be changed either forward or backward by pulling the crown out to the set position and turn through 24 hours in either direction. The date can be changed only in the increasing direction by first pushing the crown into the run position and then turning the crown in the counter-clockwise direction. The date will increase one number from each half turn of the crown. Do not attempt to turn the crown clockwise when in the run position. Basic servicing techniques are similar to those used for the Model 40 except that all hands must be removed prior to removing the dial.

# the TIMEX Model 42 Movement (exploded view)

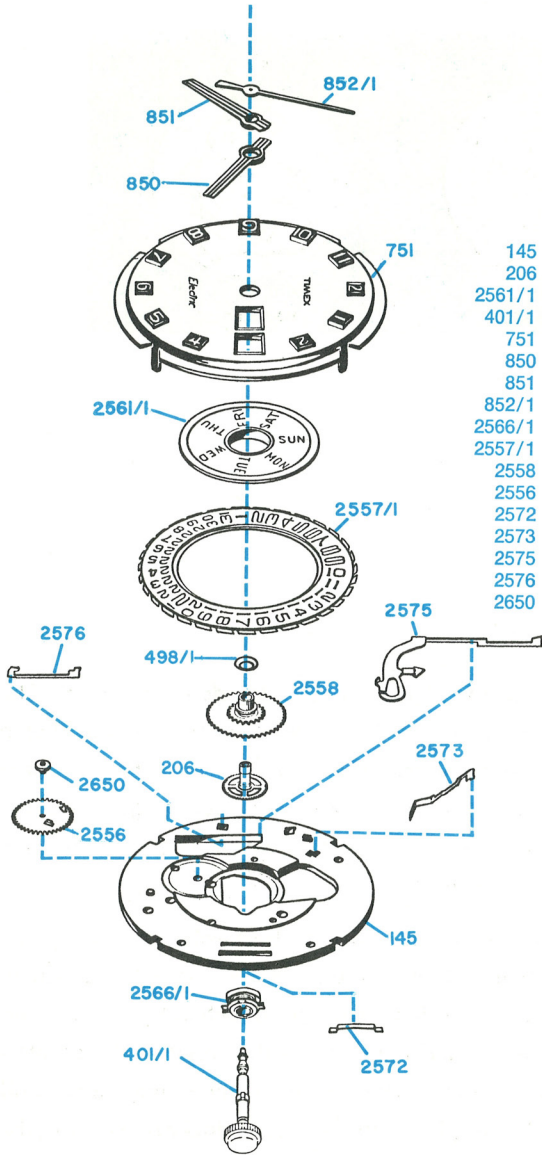

- 145 DIAL REST
- 206 CENTER WHEEL ASSEMBLY
- 2561/1 DAY FRAME ASSEMBLY
- 401/1 CROWN & STEM
- 751 DIAL
- 850 HOUR HAND
- 851 MINUTE HAND
- 852/1 SWEEP SECOND HAND
- 2566/1 DATE SET DISC ASSEMBLY
- 2557/1 DATE RING
- 2558 HOUR WHEEL
- 2556 DATE WHEEL
- 2572 DATE SET DETENT SPRING
- 2573 DAY DETENT SPRING
- 2575 DATE LEVER
- 2576 DATE CLICK SPRING
- 2650 DATE WHEEL STUD



## Disassembly of Movement (model 42)

The first step in disassembling the movement is to remove in order (as described on pages 40.3 and 40.4 of the Timex Service Manual) the caseback, energy cell, movement cover, crown and stem assembly (be careful to pick out the Date Set Disc Assembly and the Date Set Detent Spring after the Crown and Stem Assembly is removed). (Figure #1) Turn the watch over and with a crystal lift remove the crystal from the bezel, lift out the reflector ring and then remove the dial and movement assembly. Note the position of the movement locating tabs inside the bezel to make reassembly easier.

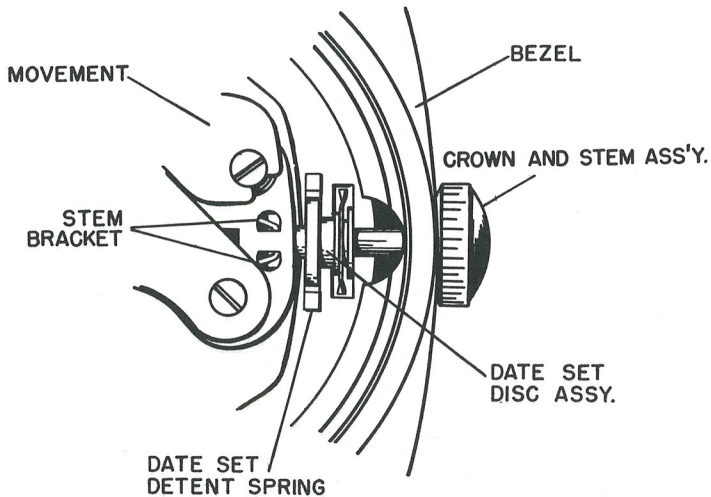

FIG. 1

# Disassembly of Movement (model 42)

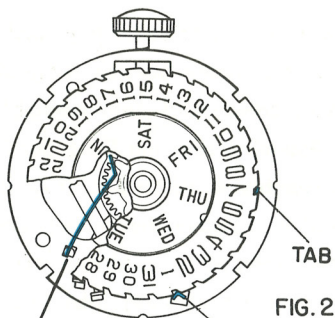

FIG. 2

DAY DETENT SPRING  
2573

DATE CLICK SPRING

LOCATING HOLE

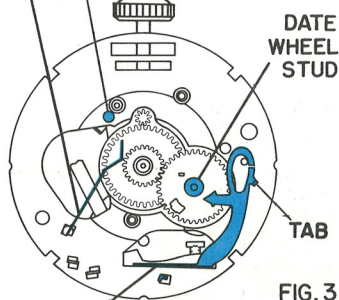

FIG. 3

DATE LEVER  
2575

GROUND SPRING  
4035

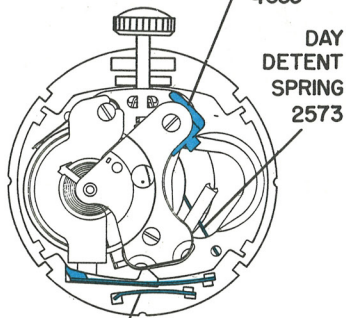

FIG. 4

DATE CLICK SPRING  
2576

Remove all hands from assembly. Turn the movement over and while holding the dial in place, bend the four dial legs up just enough to permit removal of the dial from the movement. Turn the movement over so the dial is up and carefully lift off the dial. Note the position of the loose parts under the dial (see figures 2, 3 and 4, and the exploded view on page 42.2), then remove in order:

- Hour Wheel Washer
- Day Frame Assembly
- Date Ring
- Day Detent Spring
- Date Wheel Stud
- Date Wheel
- Hour Wheel
- Center Wheel

It is not necessary to remove the Date Lever and the Date Detent Spring.

The movement assembly may now be disassembled and serviced as detailed on pages 40.5 through 40.12 of the Timex Service Manual.

## Reassembly of Movement (model 42)

After the electric movement has been serviced following the Model 40 procedures, care must be exercised in reassembling the dial and indexing parts of the model 42 in order to assure proper functioning.

First assemble the Setting Stem and Crown into the movement (do not put in the Date Set Disc Assembly and Date Set Detent Spring at this time) and place the movement in the dial up position. Next, assemble in order as shown in the exploded view on page 42.2 and in figures 2, 3 and 4:

- Center Wheel
- Hour Wheel
- Date Wheel
- Date Wheel Stud
- Hour Wheel Washer

Insert the Day Detent Spring into the proper slot in the Dial Rest and carefully deflect the end of the spring until it can be temporarily hooked under the edge of the Dial Rest (see figure 5).

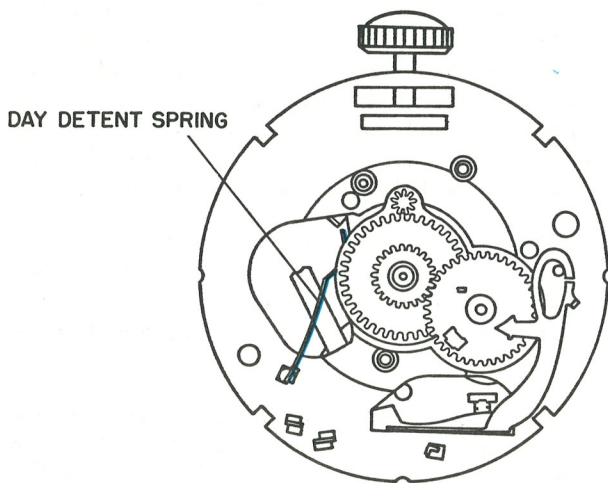

FIG. 5

## Reassembly of Movement (model 42)

Visually examine the Date Ring to be sure it is not bent or damaged. Place the Date Ring on the Dial Rest and position it against the end of the Date Click Spring and the tab on the Date Lever. Position the Date Ring as near the center as possible. (See figure 2)

Lubrication: The Day and the Date mechanisms must be lubricated before the Dial is assembled to the movement. (Elgin M56B oil is the watch lubricant used in the factory). Apply a small amount of watch oil at:

- A. Junction of Date Lever and Guide Stud.
- B. Both sides of Nose of Date Lever
- C. Tab of Date Lever (Inside Surface).
- D. Date Wheel at bearing with Date Wheel Stud.
- E. Date Click Spring where it contacts Date Ring.
- F. Contact surface of Day Detent Spring.

Examine the Day Frame Assembly for damage and be sure the pinion is free to turn. (Lubrication: The Bearing seat of the Date Wheel on outer dimension of the Day Frame should be lubricated with a small amount of watch oil (Elgin M56B is the watch oil used in the factory ). Note the flat on the edge of the day frame assembly. Holding the Day Frame Assembly so the flat is toward the crown and parallel to the slot in the Dial Rest, place it on the movement. Apply slight pressure on the day frame and move it slightly until it is centered and drops into place on the Date Wheel Stud and into the hole in the Dial Rest (see figure 3).

Carefully place the Dial on the movement so the dial legs are in the slots, then, holding the dial firmly in place, turn the movement over and bend the legs to secure the assembly. With a tweezer or small screw driver, reach through the movement and release the hooked end of the Day Detent Spring.

Pull the Setting Stem with Crown into the set position, then, with the movement in the dial down position, turn the crown clockwise and observe the movement of the end of the Date Lever. The end of the lever first deflects under the plate and then will snap out. When the lever snaps out, push in the crown, turn the movement over and assemble the hands to the 12 o'clock position.

## Reassembly of Movement (model 42)

Remove the Setting Stem With Crown assembly (see page 42.3).

Place the dial and movement into the bezel being careful to position so the movement locating tab is in the proper position. Position the reflector ring and replace the crystal. Turn the watch over and place the Date Set Detent Spring in a slot in the Dial Rest. Position the Date Set Disc Assembly on the spring and insert the Setting Stem and Crown through the Bezel, through the Date Set Disc and into the set position in the movement. (Lubrication: A small amount of watch oil (Elgin M56B is used in the factory) should be applied to one side of the cam lobe and to the bearing point of the cam on the stem.)

Examine the Energy Cell Ground Spring in the movement to be sure it is in the proper position to prevent a short circuit and to assure proper grounding. (see figure 4).

Position the Movement Cover in the Bezel, but in the Timex Energy Cell\* and snap in the case back. Push the crown into the run position and check that watch runs. Test function of the Day change and the Date change.

\*Use of an energy cell not meeting TIMEX specifications may cause a Timex watch to malfunction. Timex Energy Cells can be obtained from your local Timex Retailers or Timex authorized Watch Service Center.