

TIMEX model 85

electric  
calendar watch

13½ lig.  
30.50 mm  
1.201 in.



The Timex M-85 (Caliber 880/881) is a 13- $\frac{1}{2}$  ligne electric calendar watch movement. The basic movement is the same as the M-84, however, a sophisticated calendar mechanism has been added to the dial side. The calendar mechanism is unique in that it is instantaneous, taking only seconds to switch the date, and because it provides a dot as an A.M./P.M. indicator along with the date numeral.

When the date numeral is viewed through the dial window, this dot is displayed either above or below the numeral. If this dot is below the numeral, it indicates A.M.; if above, it indicates P.M.

The date can be set manually by rotating the hands. For quick date setting, move the hands counterclockwise to approximately 9:00 o'clock and then clockwise to just past 12:00 o'clock.

Since watch contains permanent magnets, no attempt should be made to demagnetize the watch.

# the TIMEX Model 85 Movement (exploded view)

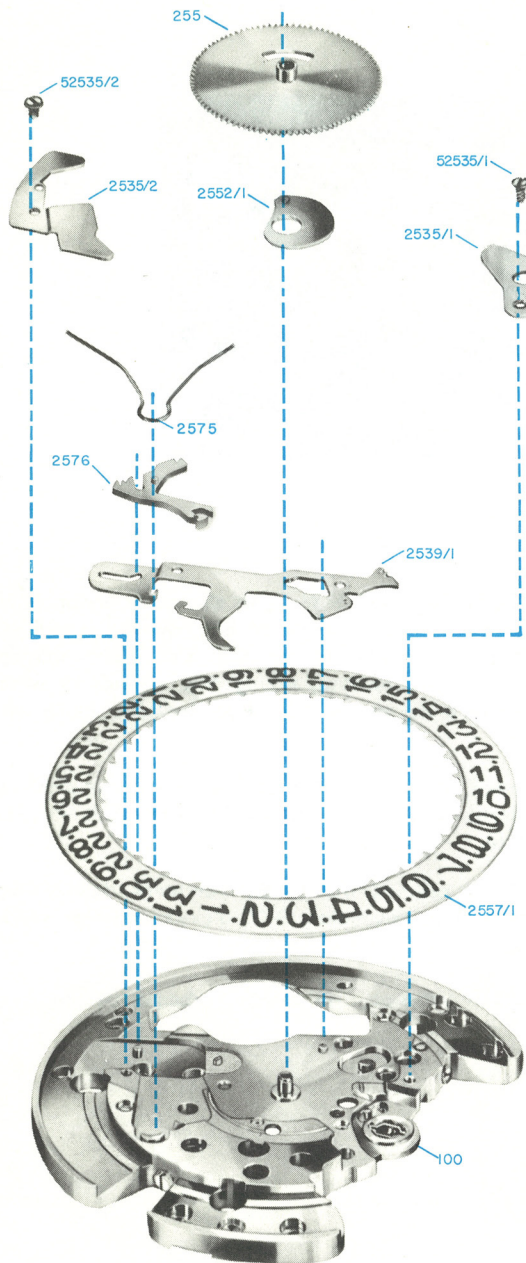

- 100 PLATE ASS'Y.
- 255 HOUR WHEEL
- 2535/1 FIRST DATE HOLDER
- 2535/2 SECOND DATE HOLDER
- 2539/1 DATE INDEXING LEVER
- 2552/1 DATE CAM
- 2557/1 DATE RING
- 2575 DATE INDEXING LEVER SPRING
- 2576 DATE CLICK
- 52535/1 DATE HOLDER SCREW
- 52535/2 DATE HOLDER SCREW

## Disassembly of Movement (model 85)

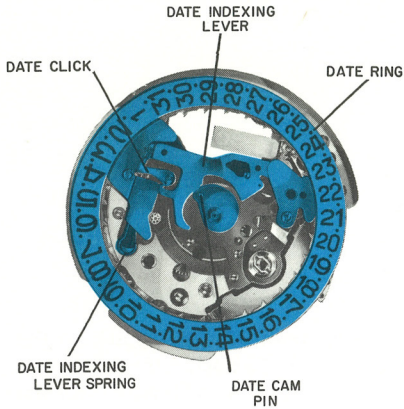

The mechanism which drives the date ring operates as follows:

The pin on the date cam is driven by the hour wheel. At 12:00, the lobe of the cam is in a position to allow the date indexing lever to drop off, move to the right, engage and advance the date ring. Since the date indexing lever is under spring tension by means of the indexing spring, this action is instantaneous. The click (No. 2576) holds the date ring in position. This click is also under spring tension by means of the indexing spring.

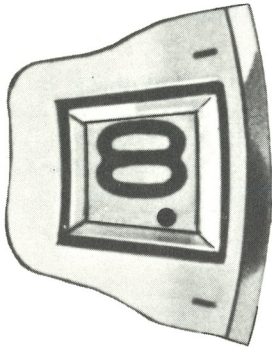

12<sup>00</sup> MIDNIGHT TO 12<sup>00</sup> NOON

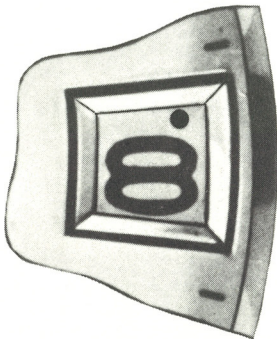

12<sup>00</sup> NOON TO 12<sup>00</sup> MIDNIGHT

Since the date cam is driven directly by the hour wheel, instead of through a reduction gear as is the case in most watches, the advancing action of the date ring in the Timex Electric occurs at both 12 midnight and 12 noon. The shape of the teeth on the index lever and date ring is such that each indexing will not move the date ring forward one full space. Instead, the date ring moves forward only  $\frac{3}{4}$  of a full space at 12 midnight and  $\frac{1}{4}$  of a full space at 12 noon. In this way, Timex has been able to provide the A.M./P.M. indicator on the date ring.

From 12 midnight to 12 noon, the date is displayed in the window with a small dot below the numeral. At 12 noon, instead of switching to a new numeral, the date ring only indexes  $\frac{1}{4}$  space and the numeral moves to the lower portion of the window and a new dot appears above the numeral indicating P.M.

## Disassembly of Movement Cont'd.

To disassemble the calendar device, remove the parts in the following order:

- a) Date cam 2552/1
- b) Second date holder 2553/2 with screw 52535/2
- c) Date click 2576
- d) Date indexing spring 2575
- e) First date holder 2535/1 with screw 52535/1
- f) Date indexing lever 2539/1
- g) Date ring 2557/1

Note — the hour hand is placed in precise angular position with the slot in the hour wheel so that date switching will occur at 12 o'clock. If it becomes necessary to remove the hand from the hour wheel, note this position so that the hand can be replaced in the same position.

## Cleaning and Lubricating The Timex Model 85

All cleaning and lubricating points indicated for the M-84 should be followed for the M-85. In addition, lubricate the bearing of the date cam 2552/1 in addition to the outer edge which bears against the date indexing lever. Lubricate the guide pins of the date indexing lever 2539/1 and the bearing and working surfaces of the date click. Lubricate the working surface of the date indexing spring No. 2575.